

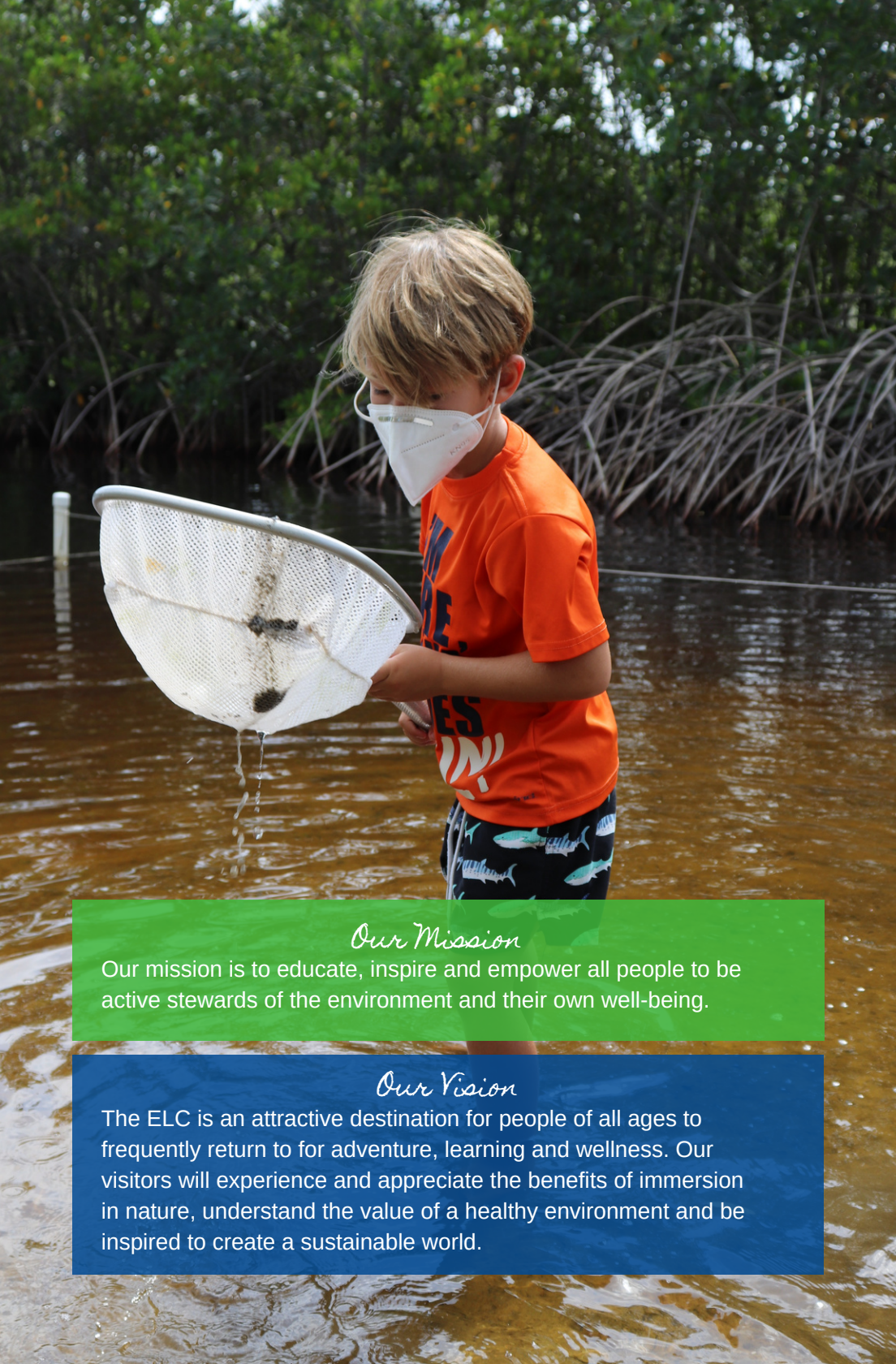

Environmental Learning Center
Annual Report 2019-2020





Our Mission

Our mission is to educate, inspire and empower all people to be active stewards of the environment and their own well-being.

Our Vision

The ELC is an attractive destination for people of all ages to frequently return to for adventure, learning and wellness. Our visitors will experience and appreciate the benefits of immersion in nature, understand the value of a healthy environment and be inspired to create a sustainable world.

What We Offer

- Environmental Programs
- Field Trips and Camps
- Interactive Exhibits
- Aquarium & Touch Tank
- Wellness Programs
- All-Terrain Wheelchairs/Walkers
- Kayak & Paddle Board Rentals
- STEAM Programs (Science, Technology, Engineering, Arts & Math)
- See Through Canoes
- Facility Rentals
- Community Events
- Pontoon Boat Tours
- Canoe Tours
- Walking Tours
- Over 2.5 Miles of Trails

The ELC fosters community awareness, appreciation and concern for the environment. We promote the use of 21st century knowledge and skills to make informed decisions, solve current environmental problems and prevent new ones.

Not only do we educate people about these issues, we empower people to be a part of the solution. ***Because everyone deserves a healthy planet.***

*We need nature.
Nature needs us.*

Our Team

Board of Directors

Donald E. Barr, *Board Chair*

John L. Daniels, *Vice Chair*

J. Robert Tench, *Secretary*

Jim Sourbeer, *Treasurer*

Barbara Schlitt Ford, *Executive Director*

Tim Buhl

Tyler G. Puttick

Jeffrey L. Susi

Jill Liddell

David Griffis

Our Staff

Barbara Schlitt Ford
Executive Director

Marcy Harrison
Finance/HR/Operations Manager

Nancy Puglio
*Volunteer & Guest Services
Coordinator*

Kenny Kinchen
Membership & Systems Manager

Sue Harr
*Relationship and Experiences
Specialist*

Lindsay Bauer
Guest Services Specialist

Amy Shea
Education Coordinator

Sara Piotter
Senior Environmental Educator

Sarah Christopherson
Environmental Educator

Ray Weatherdon
Facilities Manager

Phil Chieco
Marine Facilities & Boat Capt.



A Letter from our Executive Director



Greetings fellow Earth Lovers, from Barbara Schlitt Ford, grateful Executive Director of our treasured Environmental Learning Center.

I'm sharing this message to give you a glimpse of this past fiscal year from our inside perspective.

Recall that I joined the ELC as Interim ED April 2018 and became the permanent ED in September 2018. In my first year at the helm, together we made great strides toward a flourishing future for the ELC.

This fiscal year was off to a great start in terms of increased program attendance as well as campus visitors, improved metrics tracking, and creative new offerings. We were poised to have a stellar year. About 1/3 of this 7/1/19-6/30/20 fiscal year ended up being derailed by the pandemic. Never one to make excuses, we made the best of the challenging situation. I just want to paint for you a mental vision of our path.

We had announced the pledge that would make possible the creation of the first key piece of our master plan, the Education and Event Pavilion. The community was excited about what this new venue would mean for us all. Just prior to the unwelcome arrival of COVID in March 2020, the ELC hosted a smashingly successful EcoFest with over 1200 attendees. The campus was buzzing with happy folks of all ages enjoying being in the great outdoors and learning more about this fascinating natural world that surrounds us. There was seining and pond dip netting, pontoon/canoe/kayak tours, a drum circle, nature crafts, guided walks, a roster of adult lectures and workshops, and loads of guests enjoying our two nature art collections and our 1500 gallons of aquaria and touch tank, and Discovery Station interactive exhibits. In the Lagoon Room, youth were thoroughly enjoying the hands-on STEAM activity center. Families and friends were exploring our miles of trails and boardwalks. Purchases were being made in our Nature Nook eco-boutique. Our amazing cadre of volunteers was everywhere to assist. It was a huge success in every way.

Likewise in January 2020, we hosted our signature fundraising event Mangroves and Moonlight. Generous supporters raved about how many wonderful things were going on at the ELC and how excited they were for the future. We had completed our 3rd-grade field trips and everyone had a blast and took home critical new knowledge about their connection to our environment and why we should all care about and protect its health.

A Letter from our Executive Director

We were in the midst of our 4th-grade field trips when the news of this community health crisis was revealed.

In February 2020 we had just hosted our brainchild, the first Indian River CARES Nonprofit Leaders Coalition - a Valentine's Day appreciation lunch for the Executive Directors of our fellow philanthropic organizations in the county. CARES stands for Connect, Advocate, Renew, Educate and Strategize. This amazing group of leaders, that does so much to improve the quality of life for so many here, vowed to come together quarterly so they could be knowledgeable about what the other nonprofits were doing and collaborate wherever possible. Little did they know at the time that just a few weeks later they would decide to meet virtually weekly while they supported each other through this unbelievably challenging time to help one another reach the other side. "Together, we are better."

As we all know, in March 2020 everything came to a screeching halt as we did everything we could to protect the health of our staff, volunteers, and visitors. As soon as it was safe to do so, we opened the outdoor campus so that the community had a safe place where they could physically distance themselves outdoors. Waiving our fees seemed like the right thing to do. This was a gift to our residents - the gift of our most valuable asset, our 64 acres of wild Florida habitat on an island in the middle of the Indian River Lagoon.

We cinched our belts and extended our hands. We trimmed our annual budget by 25%. We unbelievably did more with less. Staff worked remotely on slightly reduced hours; volunteers stayed home and hunkered down like the rest of the country. ELC leadership delivered nature puzzles to the nursing homes and assisted living facilities with notes of cheer to let them know they were in our thoughts and hearts. We reached out to our donors and members to see what we could do to help.

Summer camps were sadly canceled. The staff got busy creating new and innovative ways to continue the ELC mission through our unique Nature Near You Kits and virtual outreach programs for schools, fellow nonprofits, and the community at large. Many were provided free of charge.

With the focus shifted from profitability to easing the burden for the community in whatever way we could, we were fortunate to receive PPP assistance and continued donor support while drawing on our Foundation reserves to see us through. Next fiscal year's annual report will reflect much of the same. But we rallied, just as the rest of the country did. We repositioned our efforts toward what was most helpful and important for society.

A Letter from our Executive Director

Globally, the importance of a healthy environment was being spotlighted. Stories about signs of ecosystem recovery as a direct result of the reduced human population stressors of industrial plants and vehicle emissions were spreading hope. People slowed down, planted gardens, spent time with loved ones, and appreciated how convenient their former lives had been.

Businesses (including nonprofit businesses) had to figure out a way to survive if not thrive. While it was certainly disappointing to not end the fiscal year in the healthy financial position we had envisioned and had strategically planned for, we were among the fortunate to firmly survive. We took the time provided to fix up our lovingly worn-for-decades campus, and continued our plans for the brighter days we knew to lay ahead.

We are stronger because of this challenge and we are so deeply grateful to our supporters who have helped us through.

Please know that the ELC is here for you and we look forward to seeing you when you want to relax, celebrate, connect, explore, ponder or grow. We hope that you will think of us as an extension of your own backyard.

Thank you for joining us as we recommit to fostering awareness of the interconnectedness of all things. We strive to instill the understanding that when we humans fail to protect and nurture such a critical aspect of our world as our natural resources that we all rely on to live, the ramifications are severe and life-threatening. Eyes and ears are being opened to this important message. The ELC is here to support our individual and collective convictions to act differently, now, while we can still turn the tide for the health of our shared environment.

With passionate conviction and humble appreciation,

Barb

Barb and your entire ELC family



OUR ANNUAL ACCOMPLISHMENTS

Highlighting the successes of our purpose-driven mission

Looking Back

July 1, 2019 - June 30, 2020



14,480
Visitors



1,535
Pontoon Boat
Passengers



819
Educator Run
Program Hours



452
Members



9
Maggie Bowman Fund
Scholarship Beneficiaries



3,401
Educational Program
Participants Served

The indoor spaces and many programs at the ELC were closed and canceled from March through June 2020 due to COVID-19.



Volunteers

“Volunteering at the ELC has been very rewarding. It gives us the opportunity to share our love for paddling and cycling while encouraging stewardship for the environment and personal well-being.”

Matt and Maggie Lechowicz

You Can Make a Difference!

Some Volunteer Opportunities Include:

- Aquaria Touch Tank & Discovery Station Docent
- Campus Maintenance/Gardening
- Roving Nature Guide
- Pontoon Boat Guide
- Greeter
- *And more!*



\$132,518
Total Value of
Volunteer Service



4,872
Hours Volunteered

Want to become a volunteer?

Email volunteer@discoverelc.org or call (772) 589-5050 ext. 107.

Fill out our online application at DiscoverELC.org/volunteer

Financial Statement

Fiscal Year July 1, 2019- June 30, 2020

Revenue

| | |
|----------------------|------------------|
| Contributions | \$504,692 |
| Special Events | \$64,092 |
| Programs | \$148,098 |
| Other | \$71,294 |
| Investment Gain | \$69,174 |
| Total Revenue | \$857,350 |

Expenses

| | |
|------------------------|--------------------|
| Program Services | |
| Educational Programs | \$983,001 |
| Support Services | |
| Management and General | \$235,908 |
| Resource Development | \$173,552 |
| Total Expenses | \$1,392,471 |

Net Assets

| | |
|------------------------|--------------------|
| Beginning of the Year | \$6,728,746 |
| Change in Net Assets | (\$535,121)* |
| End of the Year | \$6,193,625 |

*Facility closure due to Covid resulted in significant revenue losses for both this fiscal year and the following. ELC leadership responded by trimming expenses 25% and drawing on reserves to cover expenses. During fiscal year '20-'21 ELC now is operating with a balanced budget.

Breaking Down the Revenue

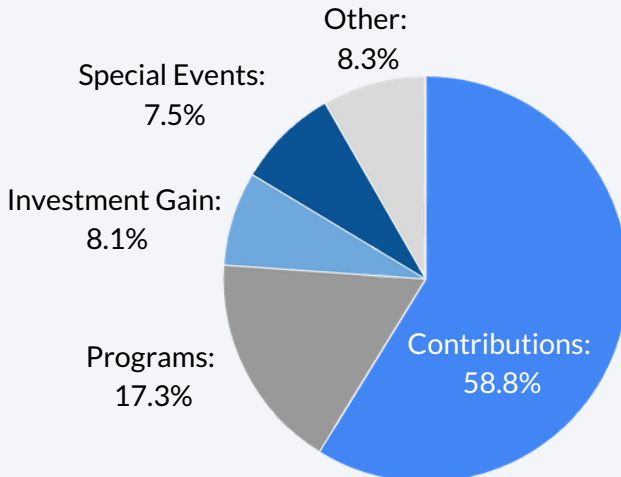

Adapting to the new normal

Nothing could have prepared the staff and volunteers for the challenges faced by the Environmental Learning Center (ELC) after March 2020 and the COVID-19 pandemic. Doors were abruptly closed. Parking lots suddenly were empty. The boats remained tied to their docks. The ELC became eerily still, absent from the daily activity of staff, students, and volunteers. There was no sound of children laughing or of our nature guides leading inquisitive guests through our lush campus. The phones went silent and our doors remained locked. But not for long.

The innovative team quickly pivoted to virtual education and focused on campus improvements. The solitude was short-lived as the leadership team of the ELC simultaneously formulated a strategic plan to re-open the campus. They knew that the ELC provided a much needed safe-haven for the community. At the ELC our family, friends, neighbors and visitors could experience the many therapeutic benefits of nature so desperately needed, especially during this time of uncertainty. Slowly and methodically the campus safely re-opened. The ELC offered its treasures using innovative planning:

- Free admission during the months of March-June, provided guests the opportunity to safely social distance outdoors and experience the healing and therapeutic benefits of nature.
- Lagoon Island Family Adventures created safe, hands-on educational adventures in the absence of summer camps.
- Nature Near You Kits provided at home educational activities for hundreds of children.
- Virtual Events were created to connect people to nature from the security of their homes.
- Through our scholarship programs, families in need were able to participate in programs both virtually and on campus.



With Appreciation...

*A special thank you to our donors.
We couldn't do it without you!*

88 Acres
Mr. Joseph Acerra
Acts 20:35 Fund
Mr. and Mrs. Jacob Adames
Ms. Karen Adelman
Mr. and Mrs. Davin Adolphson
Mr. Daniel Ahlfeld and Ms. Rosalie Hakker
Mr. and Mrs. Don Aldrich
Alex G. Nason Foundation, Inc.
Alex MacWilliam Inc. Real Estate
Mrs. Brenda Allen
Mr. and Mrs. Michael Allers
Mr. and Mrs. Brad Allin
Amazon Smile Foundation
Mr. and Mrs. Michael Amoroso
Mr. and Mrs. Peter Anderson
Mr. and Mrs. Thomas Anderson
Mr. and Mrs. Ty Anderson
Mrs. Francesca Anderson
Ms. Pam Anderson
Ms. Carol Andrews
Anonymous Donors
Mrs. Lois Appleby
Mr. and Mrs. Jason Aquilino
Archie S. Wingfield, Jr. Charitable Trust
Ms. Amber Armstrong
Ms. Sharon Armstrong
Mr. and Mrs. Leo Arnold
Mr. and Mrs. William Arnold
Ms. Montana Atwater
Mr. and Mrs. Jerry Babicka
Mr. and Mrs. Colin Bailey
Ms. Susan Baker
Dr. and Mrs. Paul Bakule
Mr. David Bankston
Big Shots Golf
Mr. and Mrs. Bill Bannister
Mr. and Mrs. David Banta
Mr. Steve Baran
Gabby Barbarite, Ph.D.
Mr. and Mrs. Andrew Barkhorn
Mr. and Mrs. Don Barr
Mr. Andrew Barr
Mr. and Mrs. Desmond Barry Jr.
Mr. and Mrs. Matthew Barth
Ms. Kerry Bartlett
Mr. and Mrs. Donald Battista
Mr. and Mrs. John Batty
Mr. J. Grant Beadle III
Mrs. Shirley Becker
Dr. Kaci Beckett
Mr. and Mrs. Dale Beckmann
Mr. and Mrs. Richard Beeman
Dr. Ann Belinkoff
Mr. and Mrs. James Bender
Mrs. Nancy Benedict
Mr. and Mrs. Harry Benham
Ms. Deborah Benjamin
Mr. Dennis Bennett
Ms. Leigh Bennett
Mr. and Mrs. William Berls
Mr. and Mrs. David Berry
Mr. and Mrs. Frantz Bertin
Ms. Marta Bertolodo
Mr. and Mrs. Robert Biear
Mr. and Mrs. Ronald Biggar
Mr. and Mrs. Peter Bijur
Ms. Heidi Billington
Mr. and Mrs. Gregg Billups
Ms. Jennifer Black
Mr. and Mrs. Robert Blackburn
Ms. Mary Blair
Ms. Cathy Blalock and Mr. Michael Lauck
Mr. and Mrs. Ronald Blank
Mr. and Mrs. Samuel Block
Mr. Eric Bobinsky and Ms. Ann Heyward
Ms. and Mrs. Jesus Bosque
Mr. and Mrs. Nicolas Bousquet
Mr. and Mrs. Stephane Bouyssou
Mr. Ryan Bowles
Ms. Alysia Bowsher
Mr. and Mrs. Dave Bradley
Mr. and Mrs. John Brady
Ms. Anne Brakman
Mr. and Mrs. William Brennan
Ms. Judith Briggs
Mr. William Broocke
Dr. and Mrs. Harold Brooks
Mr. and Mrs. David Brown
Ms. Sandra Brownett
Mr. Charles Browning
Mr. Robert Bruce and Ms. Janice Broda
Mr. and Mrs. Francois Brutch
Mr. and Mrs. Vaughn Bryson
Mr. and Mrs. John Buckley
Ms. Brielle Buckley
Mr. and Mrs. Anthony Buford
Mr. and Mrs. Timothy Buhl
Mr. and Mrs. William Bull
Mr. and Mrs. Peter Burchfield
Mr. and Mrs. Jay Burgess
Mr. and Mrs. David Burke
Mr. and Mrs. Fred Burt
Mr. and Mrs. James Byrnes
Mr. and Mrs. Steven Calabrese
Mr. and Mrs. Pete Cameron
Mr. Thomas Cannon
Capt. Hiram's Resort
Mr. and Mrs. David Carlson
Ms. Christina Carlson
Mr. and Mrs. Leslie Carter
Ms. Joy Carter
Mr. and Mrs. Jack Casselberry
Mr. and Mrs. Jeremy Cassell
Mr. and Mrs. Todd Cassidy
Mrs. Elizabeth Cates
Mr. and Mrs. David Cearley
Mr. and Mrs. David Cerchie
Mr. and Mrs. Michael Charecky Sr.
Chelsea's on Cardinal
Ms. Amanda Christopherson
Ms. Jess Christopherson
Ms. Melissa Christopherson
Ms. Sarah Christopherson
Ms. Sherri Cipriani
Mr. and Mrs. Gary Cito
Mr. and Mrs. William B. Clemens Jr.
Mr. and Mrs. Gregory Clements
Dr. Linda Clerch
Mr. and Mrs. Chris Clifford
Mr. and Mrs. Kevin Coffey
Ms. Jean Cohen
Mr. and Mrs. Ronald Colaianni Jr.
Mr. and Mrs. Wallace Cole, III
Mr. and Mrs. William Coleman
Mr. and Mrs. Jim Colliflower
Mr. and Mrs. David Collins
Community Veterinary Clinic LLC
Mr. and Mrs. Peter Conant
Mr. Peter Conley and Ms. Martha Downes
Mr. and Mrs. George Connelly
Mr. and Mrs. Gerald Coogan
Ms. Veronica Corpuz and Mr. Alex Thompson
Mr. Randy Correll
Mr. and Mrs. Louis Costa
Mr. and Mrs. Donald Couture
Mr. and Mrs. Nelson Cover

Donors

Mr. and Mrs. Philip Coviello
Mr. and Mrs. Paul Covill
Mr. and Mrs. Jeffrey Cowhey
Dr. David Cox and Dr. Lorraine Heisler
Mr. and Mrs. Mike Cracraft
Mr. and Mrs. John Crosby
Mr. and Mrs. Bruce Culp
Mr. and Mrs. Alan Curtis
Mr. John Curtis
Ms. Dolores Damore
Mr. and Mrs. John Daniels
Ms. Diana Daniels
Ms. Terry Daulton
Ms. Nancy Davis
Mr. and Mrs. Edward Dayton
Mr. and Mrs. Michael DeChants
Mr. and Mrs. Samuel Deckert
Mr. and Mrs. Alfred DeCrane Jr.
Ms. Brittany Delancey
Dr. and Mrs. Dino DeGaudio
Mrs. Alice Dember
Mr. and Mrs. Lephiew Dennington
Ms. Hester Denniston
Mr. and Mrs. Joseph Denny
Mr. Chadd Deo
Mr. and Mrs. Timothy Detman
Mr. Michael Devlin
Ms. Joan Di Gregorio
Ms. Dorothy Didrichsons
Ms. Giacomina DiGregorio
Mr. and Mrs. Charles A. Dill
Disney VolunTEARS Grants
Ms. Lisa Djahed
Mr. and Mrs. Andrew Dlugosz
Mr. and Mrs. John D'Luhy
Mr. Matthew Dodds
Mr. Robert Doernberg and Ms. Margaret Sweeney
Mr. and Mrs. Kenneth Domanski
Ms. Connie Dominanni
Donadio and Associates, Architects, PA
Mr. and Mrs. J. Bennett Donaldson Jr.
Mr. and Mrs. Garrett Donlin
Mr. and Mrs. Ed Donnelly
Mr. George Donohue
Mr. and Mrs. James Donovan
Mr. and Mrs. James Doty
Ms. Miriam Drew
Mr. and Mrs. David Driver
Mr. and Mrs. Charles Duncan
Mr. Robin Dunlap Jr.
Mr. and Mrs. Scott Dunlop
Mr. and Mrs. Christopher Dunn
Mr. and Mrs. Charles Dunton
Mr. and Mrs. Paul Duplantis
Mr. and Mrs. Alan Edelstein
Mr. and Mrs. David Ederer
Edlund, Dritenbas, Binkley
Architects and Associates, P.A.
Mr. and Mrs. Robert Edmiston
Mr. and Mrs. Dean Edwards
Mr. and Mrs. Jack Edwards
Mrs. Joan Edwards
Mr. and Mrs. Ronald Ellis
Mr. and Mrs. Colin Emerson
Ms. Wendy Emerson
Mr. and Mrs. Mike Enriquez
Ms. Deborah Eschenbacher
Mr. and Mrs. Bowers Espy
Mr. and Mrs. Donald Everett
Facebook Donors
Facial Rejuvenation FL
Mr. Robert Farber
Ms. Jacqueline Farrell
Ms. Grace Fasolino and Ms. Josephine Horne
FAU Harbor Branch
Oceanographic Institute
Mr. Philip Fauntleroy and Ms. Alice McKenna
Mr. and Mrs. Robert Fazekas
Ms. Jennifer Fee
Mr. and Mrs. Todd Fennell
Mr. and Mrs. Raymond Ferrari
Mr. and Mrs. Maurice Ferris Jr.
Mr. and Mrs. Charles Festo
Ms. Lauren Fiabane
Ms. Sheana Firth
Mr. and Mrs. Gary Fischer
Mr. and Mrs. Morgan Fischer
Mr. and Mrs. Dan Fitzgerald
Mr. and Mrs. Tom Fleming
Ms. Jane Fleming
Mr. and Mrs. William Fletcher
Mr. and Mrs. Thomas Flinn
Florida Inland Navigation District
Mr. and Mrs. Patrick Flynn
Mrs. Jennifer Foley-Anderson
Mr. and Mrs. Miguel Fonseca
Dr. and Mrs. Michael Fortunato
Ms. Flossie Fowlkes
Ms. Elizabeth Frappier
Mr. and Mrs. Brian Freeman
Mr. and Mrs. William French III
Mr. and Mrs. Charles Frey
Mr. and Mrs. William Friesell
Mr. and Mrs. Mike Fry
Mr. and Mrs. James Fuller
Mr. and Mrs. Bill Funaro
Ms. Dinah Gabany
Mr. and Mrs. Michael Gabriel
Mr. and Mrs. Fred Gaertner
Mr. and Mrs. Robert Gamble
Garden Club of Indian River
County, Inc.
Mr. and Mrs. Walter Garrard
Mr. and Mrs. John Garrison
Mr. Owen Garrison
Ms. Lorraine Gartner
George E. Warren Corporation
Ms. Ann Gerritsen
Mr. Anthony Giaquinto
Mr. and Mrs. Gary Gilbert
G.K. Environmental, Inc.
Mr. Tim Glover
GMOT, LLC
Mr. and Mrs. Jeffrey Golden
Ms. Stacy Rogers Golding
Mr. and Mrs. Tom Goldman
Ms. Debbie Goldsby
Ms. Margaret Goodknight
Gookin Estate
Ms. Amanda Grabau
Ms. Margaret Graham
Ms. Sandra Graham
Ms. Susan Grandpierre
Mr. and Mrs. Doug Graybill
Mr. and Mrs. Mike Green
Ms. Barbara Greene
Mr. and Mrs. Robert Grice
Mr. and Mrs. Albert Griffiths
Mr. and Mrs. Richard Gromis
Grove Isle at Vero Beach
Mr. and Mrs. Joseph Grow
Mr. and Mrs. Thomas Gruber
Mr. Roger Grusky and Mrs. Hope Eiseman
Mr. and Mrs. Ron Grzymkowski
Mr. and Mrs. Brent Guay
Mr. and Mrs. Paul Guthrie
Ms. Julie Guthrie
Mr. and Mrs. Jay Haberland
Mr. and Mrs. Duke Habernickel
Mr. and Mrs. Roger Haines
Mr. and Mrs. Billy Hale
Mr. and Mrs. Steve Hale
Mr. and Mrs. Ronald Hall
Mr. Edward Halsey
Mr. and Mrs. George Hamner, Jr.
Mr. and Mrs. Gus Hancock
Mr. Richard Hangen and Mrs. Claire A. Hangen
Mr. and Mrs. Paul Hanson
Ms. Yvonne Harrington
Mr. and Mrs. Bob Harris

Donors

Marcy Harrison and Emil Guirgis
Ms. Jean Hathaway
Ms. Norma Hathaway
Mr. Edward Hauser
Ms. Marilyn Headley
Mr. and Mrs. Donald Heeter
Mrs. Elaine Heile
Kenneth and Ginger Heller
Mr. and Mrs. James Henderson
Mr. and Mrs. George Henkel
Mr. and Mrs. Wolf Hennig
Mr. and Mrs. George Henninger
Mr. and Mrs. Leopoldo Henriquez
Mr. and Mrs. Ernest Hepler
Ms. Paula Herger
Ingmar Herrmann
Ms. Cynthia Hersh
Mr. and Mrs. Mike Hickox
Hidden Water
Ms. Cheryl Highstreet
Ms. Sheralee Hill
Ms. Pam Hill
Mrs. Grace Hinkley
Mrs. Beverly Hipkins
Mr. and Mrs. Chris Hiser
Mr. Joseph Hlista
Mr. Brent Hockman
Mr. and Mrs. Craig Hoffman
Mr. and Mrs. Thomas Hohmann
Ms. Susan Hojak
Ms. Margaret Holden
Dr. and Mrs. Nick Hopkins
Mr. and Mrs. Sherman Hotchkiss
Mr. and Mrs. Edward How, Jr.
Mr. and Mrs. Roy Howard Jr.
Mr. Robert Howard
Mr. and Mrs. Timothy Hultquist
Ms. Susan Hunter and Mr. Doug Watson
Mr. and Mrs. Charles Hutchinson III
Mr. and Mrs. Edward Hutton Jr.
Mr. and Mrs. Michael Hyde
Mr. and Mrs. Thomas Hynes
Dr. and Mrs. Charles Infante
Mr. and Mrs. James Irvin II
Mr. and Mrs. William Jackson
Mr. and Mrs. Jake Jandreau
Ms. Lisa Jeffra
John's Island Real Estate Co.
Mr. and Mrs. Galen Johnson
Mr. and Mrs. Marcus Johnston
Mr. and Mrs. Ellis Jones
Mr. and Mrs. Jeffery Jones
Ms. Edith Jones and Mr. Ralph Johansen
Ms. Robin Jones
Mr. and Mrs. Richard Joseph
Mr. Michael Kadish
Mr. and Mrs. George Kahle Jr.
Ms. Mary Kamb
Mr. and Mrs. Paul Kane
Mrs. Susan Kasten
Karen Katen and Robert Williams, Jr.
Mr. and Mrs. Nick Kavallieratos
Mr. and Mrs. Craig Keatley
Keeler Motor Car Company
Charitable Foundation
Mr. and Mrs. Larry Keesling
Ms. Kathleen Keiser and Mr. Karl Malin
Mr. and Mrs. Scott Keith
Ms. Christina Kelley
Mr. and Mrs. Ronald Kelly
Sienie Kelly
Dr. and Mrs. Alastair Kennedy
Mr. and Mrs. Jim Kennedy
Mr. and Mrs. Roger Kennedy
Dr. and Mrs. William Kent
Mr. and Mrs. Regan Kenyon
Mr. and Mrs. Michael Kerby
Ms. Donna Keys
Mr. and Mrs. Timothy Kiggins
Ms. Patience Killen
Dr. and Mrs. David Kilpatrick
Mr. and Mrs. Kenny Kinchen
Mr. and Mrs. Dennis King
Mr. and Mrs. James King
Mr. Tim Kinney
Ms. Katha Kissman
Kiwanis Club VB Treasure Coast
Mrs. Joan Klimm
Mr. and Mrs. Dimitiri Klinkowsky
Mr. and Mrs. Paul Knapp
Mr. and Mrs. Jim Knierim
Mr. and Mrs. C. Reed Knight
Mr. and Mrs. Andrew Kostanecki
Mr. and Mrs. Kurt Kristiansen
Ms. Vicki Kuhl
Mr. and Mrs. Anthony Kuiper
Mr. and Mrs. Joe LaGuardia
Mr. and Mrs. Justin Lamb
Mr. and Mrs. Roy Lambert
Mr. and Mrs. Allan Lamport
Mr. and Mrs. John Landreth
Ms. Laura LaPorte
Mr. and Mrs. Donald Larson
Mr. and Mrs. William Lavigne Jr.
Mr. and Mrs. John Leach
Mr. and Mrs. Larry Leach
Mr. and Mrs. Matthew Lechowicz
Ms. Lorraine Ledford and Mr. Gerry Nadler
Mr. and Mrs. John Lehnhardt
Mr. and Mrs. James Lenehan
Ms. Karen Levasseur
Mr. Stanton Levin
Mr. and Mrs. Robert Lewis
Mr. and Mrs. Buchanan Lilley
Mr. and Mrs. Robert Lincoln
Mr. and Mrs. Daniel Liparini
Mr. Art Litowitz
Mr. and Mrs. John Lobsitz
Mr. and Mrs. Charles Lockwood
Mr. and Mrs. Dennis Logan
Mr. and Mrs. Robert Logan
Ms. Lucinda Lormier
Ms. Sonya Louise
Mr. and Mrs. Mark Loyacano
Mr. and Mrs. Mark Lucas
Mrs. William Ludwig
Ms. Ingrid Lundberg
Mr. and Mrs. Gerard Lynch
Ms. Heather Lynn
Mr. and Mrs. William MacDonald
Ms. Ann Macdougall
Mrs. Betty MacMillan
Mr. and Mrs. Douglas Macrae
Mr. Alex MacWilliam IV
Ms. Elise Mahovlich
Mr. and Mrs. Adam Maisak
Mr. and Mrs. Raymond Malamet
Ms. Barbara Mandell
Mr. and Mrs. Gordon Mann
Mr. and Mrs. Frederick Marino
Mrs. Carol Marino
Mr. Daniel Marion and Ms. Irina Voronina
Ms. Diane Marquis-Sebie
Mr. and Mrs. Richard Marra
Mr. and Mrs. George Marshall
Mr. Robert Marshall
Mr. and Mrs. Gene Martello
Robert and Margaret Martin
Mr. Marc Mason
Mr. and Mrs. Donald Maxfield
Mr. and Mrs. Robert J. McCabe
Mrs. Eleonora McCabe
Mr. and Mrs. Ralph McCrea
Mr. and Mrs. Peter McCurrach
Mr. and Mrs. Richard McDermott
Mr. and Mrs. Randell McGrath
Mr. and Mrs. Gregory McIntosh
Mr. and Mrs. C. Michael McKeever
Mr. and Mrs. Steven McKeever

Donors

Dr. and Mrs. David McKenna
Mr. and Mrs. James McKenna
Mr. and Mrs. Michael McLaughlin
Ms. Linda McNeal
Mr. and Mrs. Roger McNeill
Ms. Kathie McRae
Ms. Khatija Meghji
Hiten and Vaishali Mehta
Mr. and Mrs. Derek Meier
Mr. and Mrs. Nicholas Melnick
Ms. Angela Mendoza Cabezas
Mr. and Mrs. Ted Meredith
Mr. and Mrs. Francis Mero
Mr. and Mrs. Hugh Meyers
Ms. Renee Mezza
Michael's On 7th
Ms. Susan Micheel
Mr. and Mrs. Socrates Mihalakos
Ms. Shirley Mikel
Mr. Glenn Miller
Ms. Virginia Miller
Ms. Sarah Milstead
Dr. and Mrs. Richard Milsten
Mr. and Mrs. Richard Minetti
Ms. Vicki Mingin
Minuteman Press
Mr. Caesar V. Mistretta
Ms. Colleen Mitchell
Ms. Patricia Mitchell
Mr. William Mlodgenski
Mr. and Mrs. Jay Moffat
Mrs. Barbara Mohler
Mr. and Mrs. Johnathan Moody
Mr. and Mrs. John E. Moore III
Mr. and Mrs. Jay Moran
Mr. Patrick Morgan
Ms. Denise Morgan
Ms. Diane Morgan and Mr. John Warner
Mr. and Mrs. Robert Morrison
Mr. and Mrs. Chalmers Morse
Ms. Michelle Morton
Mr. and Mrs. Eric Mosblech
Ms. Laura Moss
Moss Krusick CPAs and Advisors
Mrs. Cynthia Mott
Moulton Layne, P.L.
Mr. and Mrs. James Mountain
Mr. Joe Moxley
Mr. and Mrs. Sean Mulanax
Mr. and Mrs. James Mulholland III
Mulligan's Beach House Bar and Grill
Ms. Katherine Mumphries
Mr. and Mrs. Samuel Murdough
Mr. Timothy Muris and Ms. Pamela Harmon
Mr. and Mrs. Doug Nace
Mr. Paul Nace
Mr. Michael Natale
Ned and Emily Sherwood
Foundation
Mr. David Neithercut
Mr. and Mrs. William Neubauer
Network for Good
Mr. and Mrs. George Neveras
Ms. Carol Ann Nix
Ms. Carolyn Norton
Mr. and Mrs. Gary Nulton
Ms. Melody Nutt
Ms. Cindy O'Dare
Offutt Barton Schlitt, CPA
Ms. Julie Ogden
Mr. and Mrs. Joseph Olekszyk
Olivia Delacruz Foundation
Ms. Megan Olson
Mr. and Mrs. Michael O'Neill
Orchid Island Golf and Beach Club
Orchid Isle Garden Club
Dr. and Mrs. John Orcutt Jr.
Mr. and Mrs. Willie Ortiz
Ms. Tara O'Shea
Ms. Christy Paciorek
Ms. Rose Palmer
Mr. and Mrs. David Parlette
Mr. and Mrs. Keith Patterson
Mr. and Mrs. Paul Pedersen
Mr. and Mrs. Bob Peirce
Pelican Island Audubon Society
Mr. and Mrs. John Pepper
Mr. and Mrs. Daniel Perkins
Perkins-Prothro Foundation
Mr. Edward Perri
Mr. and Mrs. Jonathan Peshke
Mr. and Mrs. Ronald Pettirossi
Mr. and Mrs. Vernon Petty
Mr. and Mrs. Gerd Pfeifle
Pfizer Foundation Matching Gifts
Program
Mr. and Mrs. Steven Philipson
Mr. and Mrs. Chris Phillips
Mr. and Mrs. Michael Pierce
Mr. and Mrs. Rod Pierce
Mr. and Mrs. Paul Brown
Mrs. Linda Piotter
Ms. Constance Pitcher
Mr. and Mrs. Alvin Polk
Mr. Charles Pollard
Ms. Janet Ponik and Mr. Gregory Hawks
Mr. and Mrs. James Poole
Mr. and Mrs. Peter Post
Ms. Carrie Poster
Mr. and Mrs. Leslie Pratt
Mr. and Mrs. Samuel Pratt
Mr. and Mrs. Dan Preuss
Mr. and Mrs. Clay Price
Mr. and Mrs. Craig Price
Ms. Eugenie Price
Mr. and Mrs. Robert Prindiville
Ms. Donna Prisley
Mr. and Mrs. David Prothro
Mr. and Mrs. Todd Prue
Dr. and Mrs. Peter J. Puchner
Ms. Cristina Pulido-Lopez
Mr. and Mrs. Craig Putnam
Mr. Tyler Puttick
Quail Valley River Club
Mr. Michael Rafferty and Ms. Sue Gottlieb
Mr. and Mrs. Barry Reardon
Mrs. Virginia Reardon
Mr. and Mrs. Thomas Recicar
Ms. Angela Record
Mr. and Mrs. Robert Reisman
Mr. and Mrs. Ronald Rennick
Ms. Ann Resnik
Mr. and Mrs. Michael Rhoads
Mrs. Maria Rhodes
Mr. and Mrs. Norman Rickard
Mr. and Mrs. Frank Rifenberg
Ms. Melissa Rinella
Riomar Shoes
Mr. and Mrs. David Robertson
Mr. and Mrs. Joel Rodriguez
Ms. Priscilla Rodriguez
Mr. and Mrs. Stuart Rogers
Mr. C. Graydon Rogers
Rogers Family Foundation, a fund of
Central Indiana Community Foundation
Ms. Jessica Rohr
Mr. and Mrs. Randolph Rolf
Mr. and Mrs. Rocco Rosca
Ms. Barbara Rose
Mrs. Colleen Rosenbaum
Mr. and Mrs. Laurence Rubinow
Mr. and Mrs. John Russo
Mr. and Dr. Alan Ryall
Mr. and Mrs. George Ryan
Mr. and Mrs. Terence Ryan
SAD Foundation
Mr. Sarthak Saini and Mrs. Nicole Lemmo Saini
Mr. and Mrs. Mark Sammartino
Ms. Sharon Sandhaus
Mr. and Mrs. Henry Sandlass
Mrs. Elsie Sanftleben

Donors

Mr. and Mrs. Joe Sansone
Mr. Mark Sansonette and Ms. Susan Winthrop
Mr. and Mrs. Humberto Santamaria
Mr. and Mrs. Donald Satterly
Mr. and Mrs. Jim Savage
Mr. and Mrs. Dennis Saver
Ms. Linda Scalco
Mr. and Mrs. Clem Schaub
Mr. and Mrs. Thomas Schidel
Dr. and Mrs. Robert Schlamowitz
Mr. and Mrs. Robert Schlather
Mr. Craig Schlitt
Ms. Barbara Schlitt Ford
Schlitt | Gonzalez Real Estate Team
Ms. Kay Schmidt
Mr. and Mrs. James Schneithorst
Mr. Franklin Schroyer
Ms. Sarah Schuh
Mr. and Mrs. Timothy Schuller
Mr. and Mrs. Frank Sciacca
Sebastian Clambake Foundation Inc.
Mr. and Mrs. John Sedor
Mr. and Mrs. Craig Seward
Mrs. Eleanor Sexton
Mr. Paul Shackford
Ms. Elliese Shaughnessy
Mrs. Beverly Shea and Mr. Paul Grzymkowski
Ms. Mariah Shelton
Mr. and Mrs. Robert Sherman
Fred and Suzi Shriner
Ms. Marjorie Shropshire
Mr. and Mrs. Anthony Sigona
Mr. and Mrs. Brian Simpson
Mrs. Sarah Sinclair
Mr. and Mrs. Matthew Sitkowski
Mr. and Mrs. Steven Sloan
Mr. and Mrs. Pete Small
Mr. and Mrs. Craig Smith
Mr. and Mrs. Robert Smith
Mr. and Mrs. David Smith
Mr. Eric Smith and Ms. Barbara Niziol
Mr. Kent Smith and Mrs. Elizabeth Bahl Smith
Ms. Marcia Smythe
Mr. and Mrs. Gerard Sniffen
Mr. and Mrs. Edward Sofield
Mr. and Mrs. James Sourbeer
Mr. and Mrs. John Souza
Dr. and Mrs. Thomas Spackman Sr.
Ms. Judy Spahn
Dr. Marilyn Sparacino and Mr. Julius Sparacino
Mr. and Mrs. Paul Spellman, Jr.
Mr. and Mrs. Michael Spence
Mr. and Mrs. Leavenworth Sperry
Mr. Spiess and Ms. Kei Andrews
Mr. and Mrs. Jake Spruit
Dr. and Mrs. Doug St. Clair
Mr. and Mrs. Bernard St. Pierre
Mr. and Mrs. Albert J. Staiti
Jaime Stalter
David Stansfield and Linda Drake
Mr. and Mrs. Austin Starkey
Mr. and Mrs. John Stearns
Ms. Anita Venner and Mr. Ira Steinberg
Mr. Andy Steinbergs
Mr. Brad Stevens
Mr. Hugh Stevenson
Mr. and Mrs. H. Milton Stewart
Mr. and Mrs. William Stewart
Ms. Rania Stewart
Mr. and Mrs. Tommy Steyer
Mrs. Elizabeth Stickley
Ms. Christine Stiefel
Dr. Peter Stifel
Ms. Marty Stinson
Mr. and Mrs. Joseph Stone
Mr. and Mrs. Donald Stoner
Stork Foundation
Mr. and Mrs. Sheldon Suga
Mr. and Mrs. Byron Sugahara
Mr. and Mrs. John Sullivan
Mr. and Mrs. Paul Sullivan
Mr. and Mrs. William Surette
Mr. and Mrs. Jeffrey Susi
Mr. and Mrs. Peter Sutherland
Ms. Leigh Swaim
Mr. and Mrs. David Swartz
Mr. and Mrs. George Taber
Mr. and Mrs. John W. Taylor III
Mr. and Mrs. Thomas Taylor
Mr. Tim Taylor
Mr. and Mrs. Joseph Tecza
Mr. and Mrs. Rob Tench
Mr. and Mrs. William Teneycyk
Terra Design Studios
The Bearded Chef
The Benevity Community Impact Fund
The Brock Davidson Fund
The Camp-Younts Foundation
The Carwill Foundation
The Corrigan-Goddard Foundation
The Hill Group
The James Ford Bell Foundation
The Kiwanis Club of Vero-Treasure Coast
The Learning Alliance, Inc.
The Minotty Family Foundation
The Perkin Fund
The Ryan Family Foundation
The Tenby Group LLC
The Warwick Foundation
Mr. and Mrs. Marc Thoren
Mr. Edward Tighe
Mr. and Mrs. Roger Tittley
Mr. and Mrs. Stephen Tobia
Mr. and Mrs. William Tobin
Mr. and Mrs. David Todd
Mr. and Mrs. William Tovell
Mr. and Mrs. Ronald Townshend
Ms. Toni Tracy
Mr. and Mrs. James Traynor
Treasure Coast Chapter Golf Course Supt. Assn.
Treasure Coast Chapter NSDAR
Treasure Coast Concessions
Mr. and Mrs. Jens Tripson
Mr. and Mrs. Louhon Tucker
Mr. and Mrs. Peter Tulloch
Luchy Turati
Ms. Candace Turgeon
Mr. and Mrs. Denis Turko
Mrs. Marjorie Hermes Mary Turley
Mr. and Mrs. James Turner
Mr. and Mrs. James Ueltschi
Mr. and Mrs. Edward Uttridge
Ms. Connie Valencia
Mr. and Mrs. Michael Van Antwerp
Ms. Susan van der Stricht
Mr. and Mrs. Bruce Van Vliet
Ms. Elizabeth Vasapollo
Mr. and Mrs. Jack Veeneman Jr.
Vero Beach and Sebastian FLASH
Mr. and Mrs. Leroy Vestal
Ms. Diane Vetromile
Martha Viterito
Mr. David Vogt
Mr. and Mrs. Fred Volk
Mr. and Mrs. Toby Wagner
Walking Tree Brewery
Ms. Sara Walsh
Ms. Abigail Walters
Ms. Judith Waskuch
Ms. Heather Waters
Mr. Robert Watkins
Mr. and Mrs. Chip Watson
Mr. Philip Watson
Mr. Ray Weatherdon
Mr. and Mrs. Daniel Wehking
Mr. and Mrs. Duane Weise
Mrs. Georgia Welles
Mr. and Mrs. Patrick Welsh

Donors

Ms. Catherine Wenzing
Ms. Victoria Wermers
Mr. and Mrs. Howard Wheeler
Ms. Autumn Wheeler
Ms. Karen White
Ms. Lynn White
Ms. Chelsea Whitehead
Mr. and Mrs. Ken Whitney
Mr. Richard Whittaker
Mr. and Mrs. Don Wickstand
Ms. Lynne Wiley
Mr. and Mrs. Timothy Williams
Mr. Christopher Williams and Ms. Elaine
Mariner
Mrs. Beth Williams
Mr. and Mrs. Paul Williamson
Ms. Janice Wilson
Mr. and Mrs. Shane Wines
Ms. Donna Winter
Mr. and Mrs. Mike Wisniewski
Ms. Marilyn Wnek
Mr. and Mrs. Fred Wood
Mr. Martin Woodhams and Ms. Nikola
Sutherland
Mr. and Mrs. Tim Wright
Ms. Theresa Wunderlich
Mr. and Mrs. John Wurzburger
Mr. and Mrs. Donald Yackel
Mr. and Mrs. Russell Yeager
Mr. and Mrs. Stanley Yellin
Mr. and Mrs. Robert York
Mr. and Mrs. Bill Younker
Mrs. Jane Zecher
Mr. and Mrs. Mathieu Zincir
Ms. Rhonda Zirkle



*"We make a living by
what we get."*

*We make a life by
what we give."*

Winston S. Churchill



Every effort is made to be accurate in our donor list. If we have omitted or misspelled your name we sincerely apologize. Please contact giving@discoverelc.org so we can correct our records.

Thank you for your support.

Donor Spotlight

Former ELC volunteer and staff Naturalist in the 1990's, David Cox has been an avid supporter of the ELC. The kids dubbed him Dr. Dave when he would lead school groups in the early days of ELC.

He served on the ELC Education Committee for years and helped design and layout the boardwalk system and canoe dock. More recently, he was a member of the ELC Master Planning Group and has conducted environmental surveys, worked on permitting for future improvements to the campus, and serves on the ELC Landscape Advisory and Interpretive Plan Committees.

Not only did Dave dedicate his time and talents to the ELC, but he also was inspired to raise funds for our mission. Dr. Dave's Blue Beard Challenge was created to raise money to support the ELC.



Executive Director, Barbara Schlitt Ford and David Cox

To show his support, he dyed his beard blue!

Our Collaborative Partnerships

Ability Resource Center
Alzheimer & Parkinson Assoc of IRC
American Association of University Women
Anglers for Conservation
Archie Carr National Wildlife Refuge
Barrier Island Center
Big Brothers Big Sisters
Boys & Girls Clubs of Indian River County
Captain Hiram's River Challenge Triathlon
City of Sebastian
Clean Water Coalition of Indian River County
Coastal Connections
Coastal Conservation Association
Cultural Council of Indian River County
DIGG Gardens
Eastern Florida State College
Florida Dept. of Health
Florida Dept. of Environmental Protection
Florida Master Naturalist Program
Florida Medical Entomology Laboratory
Florida Native Plant Society
Florida Fish & Wildlife Conservation Comm.
Friends of St. Sebastian River
Gifford Youth Achievement Center
Grand Harbor Community Outreach Program
Harbor Branch Oceanographic Institute
Head Start of Indian River County
Home Depot
Homeless Children's Foundation of IRC
Indian River CARES
IRC Recreation Department
IRC Solid Waste Disposal District
IRC Stormwater Division
IRL Aquatic Preserves
IRL National Estuary Program
Indian River Citrus Museum
Indian River Community Foundation
Indian River County Chamber of Commerce
Indian River Land Trust
Indian River State College
Keep Indian River Beautiful
Kiwanis Youth in Action
LaPorte Farms
Laura Riding Jackson Foundation
Leave No Trace
Master Gardeners UF/IFAS extension
Mental Health Association
Moonshot Community Action Network
Oxbow Eco-Center
New Normal Society
Pelican Island Audubon Society
Pelican Island Conservation Society
Pelican Island National Wildlife Refuge
Quail Valley Charities
Save the Chimps
School District of Indian River County
Sea Turtle Conservancy
Sebastian River Area Chamber of Commerce
Sebastian Clambake Foundation
Sebastian Inlet District
Sebastian Natural Resources Board
Senior Resource Association
Smithsonian Marine Station
St. Johns River Water Management District
Sustainable Events Network
Sustainable Kashi
The Learning Alliance
U.S. Fish and Wildlife Service
United Way of Indian River County
Vero Beach Museum of Art
Waste Management
Youth Guidance Mentoring Academy
Youth on a Mission

Community Leaders

Indian River CARES

Indian River CARES is a coalition of nonprofit leaders that initially came together in the spring of 2020, under the leadership of ELC Executive Director, Barbara Schlitt Ford. The goal of the coalition is to build bridges between nonprofits so that they can be knowledgeable about the services provided in Indian River County and to encourage collaboration between community organizations to most efficiently use limited resources.



This coalition also works together to bring resources and speakers to help one another strengthen the staff, board of directors, and processes for the benefit of those they serve. They work to connect community members and businesses with their organizations. They identify community issues and work together to help solve them. They firmly believe that together, we are better!

Environmental Leaders Coalition

The Environmental Leaders Coalition of IRC was formed in 2020, spearheaded by ELC Executive Director, Barbara Schlitt Ford, as means of keeping the various environmental organizations and agencies in the county connected and informed. These environmental leaders work together to make sure the public is informed as to what each group is working on and how we can each support these important efforts.



The resulting collaborations serve to most efficiently use limited resources to make positive impacts for our local ecosystems. The Coalition established priorities with the most pressing being the health of the Indian River Lagoon, as well as restoration of biodiversity and protection of natural areas among a host of other environmental topics.

The ELC Foundation

The Environmental Learning Center (ELC) Foundation, Inc. is a separate not-for-profit corporation that serves as a sole support organization to the Environmental Learning Center, Inc. and manages both funds designated by the board for long-term investment and funds permanently restricted by donors for investment in perpetuity.

The ELC Foundation utilizes an internal committee of financial stewards who manage the Foundation's assets. Through prudent oversight, this Investment Committee has ensured rates of return that have performed solidly over a ten-year period.

Foundation Board of Directors

Todd Fennell, *Chair*

Donald E. Barr

Alice Cole, *Vice Chair*

Tim Buhl

Jim Sourbeer, *Secretary*

Haydn Cole

John Daniels, *Treasurer*

John D. Lowenberg, Sr.

Investment Committee: Robert Prindiville

Platinum GuideStar Rating

In 2020 the Development team at ELC worked hard to successfully improve our rating from Bronze to Platinum rating from GuideStar, an information service that specializes in reporting on US nonprofits.



We're proud to use GuideStar Platinum to share our full and complete story with the world. To reach the Platinum level, we added extensive information to our Nonprofit Profile: basic contact and organizational information; in-depth financial information; quantitative information about goals, strategies, and progress toward our mission.

Ways to Give

Why Give?

Because everyone deserves a healthy planet.

We all know giving helps others, whether we volunteer for organizations, offer emotional support to those around us or donate to charities. But studies show that giving is also good for the giver by boosting physical and mental health.

So many ways to give...

- Invite ELC to speak at your service club, HOA or business.
- Volunteer. There are dozens of ways to volunteer and share your time and talents while supporting the ELC.
- Sponsor an event or program.
- Make an in-kind donation of goods or services.
- Make a charitable donation.
- Give the gift of membership.
- Create a lasting legacy with planned giving.
- Give appreciated assets.
- Make your mark with our naming opportunities.
- Support the ELC with Qualified Charitable Distributions.
- Make a difference with IRA Charitable Rollover.
- Match a donation with your employees or members.
- Make a memorial donation with the ELC.
- Create long-term stability by giving to the ELC Foundation Endowment.

Email Give@DiscoverELC.org or
call (772) 589-5050 for more information.

Families Unplugged in Nature

Be a Part of the Plan.

Fundraising Goal: \$100,000

We envision a place where children can escape from technology, a place where they can go back to the basics and participate in nature play. Our proposed FUN Zone (Families Unplugged in Nature) will give children the opportunity to have these experiences.

The FUN Zone aims to reconnect children and their caregivers to nature - to feel more comfortable with taking their own adventures and learning about the environment through joy-filled, participatory and open-ended free play.

Physical, emotional and social health is strengthened as children work to resolve problems, overcome challenges and get wild!

FAMILIES
UNPLUGGED
in
NATURE



Email Give@DiscoverELC.org or
call (772) 589-5050 for more information.

Epoxy Flooring System

Bring the Discovery Station to Life!
Fundraising Goal: \$35,000

The ELC provides hands-on, immersive learning in our Discovery Station. With over 15,000 visitors a year, the Discovery Station teaches and entertains guests through aquariums, touch tank, and interactive rotating displays and exhibits.

Ecosystem immersion is the most effective way to teach. With our proposed epoxy ecosystem flooring, the entire room would be a learning experience from top to bottom. We are planning to create a total of five different ecosystems throughout the Discovery Station.

Our goal is to provide an immersive, educational ecosystem flooring in our Discovery Station. Imagine our Discovery Station with brighter, artistic, and colorful flooring showcasing the many ecosystem habitats around the Environmental Learning Center. We want to give our guests that immersive experience.



Email Give@DiscoverELC.org or
call (772) 589-5050 for more information.

Splash Pad

Wet and wild fun at the ELC
Fundraising Goal: \$150,000

The splash pad will be the "coolest" addition to the new Thomas R. Schidel Education and Event Pavilion and Oval, allowing children and families to cool off in sprinklers and spouts bursting with water.

The envisioned splash pad will be situated right in front of the pavilion stage and will also act as an entertaining fountain during performances. The mosaic front wall of the stage will be an educational art display of life in the Indian River Lagoon, allowing children to be immersed in a watery world.

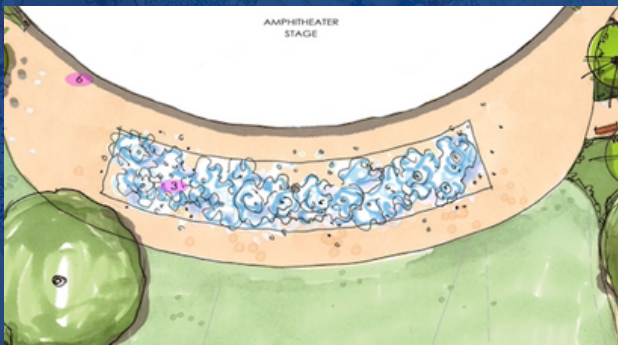

Email Give@DiscoverELC.org or
call (772) 589-5050 for more information.

Living Walls

Greening the new pavilion.

Fundraising Goal: \$20,000 per wall or
\$35,000 for both walls

The new Thomas R. Schidel Education and Event Pavilion is envisioned to have two sides of living walls. The living walls, made of native plants, will be both an environmentally friendly addition to the building and a teaching tool for the community to learn the benefits of greening structures.

Living walls are a vertical built structure intentionally covered with vegetation. They help to remove air pollutants, provide shade and thermal benefits to buildings, improve biodiversity, attenuate rain water and improve a sense of well-being.

Your donation to this project will help inspire others to install living walls by seeing the benefits first hand at the ELC.



Email Give@DiscoverELC.org or
call (772) 589-5050 for more information.

ELC for ELC

Leave your mark \$1,000 per plank Discounts available for multiple planks

The ELC wants to be the keeper of your memories, and we hope you will help us reshape a brighter future as we revitalize and recover together. Now is the time for us to revamp our beloved campus, and you can be a part of it. People of all ages visit the ELC every year and leave the same footprints on our boardwalks and trails. We want to continue to inspire those people who have walked our campus and share our passion for the environment while encouraging others to get outside and immerse themselves.

When you purchase a plank, you will be leaving your mark on campus while helping the ELC revitalize its infrastructure so we can continue to be the place where memories are made. The Lumberock Premium Decking planks are made to last 25 years, ensuring a long-term investment.

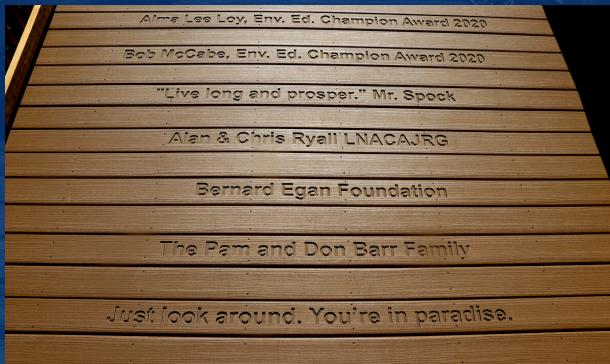

Email Give@DiscoverELC.org or
call (772) 589-5050 for more information.



Our Mission

Our mission is to educate, inspire and empower all people to be active stewards of the environment and their own well-being.

255 Live Oak Drive, Vero Beach, FL 32963

(772) 589-5050

www.DiscoverELC.org

#DiscoverELC